



## Room 2, 98 Gigant Street, Salisbury, Wiltshire, SP1 2BQ

A FURNISHED ROOM ON THE FIRST FLOOR OF THIS CHARACTER THREE STOREY PROPERTY. SINGLE OCCUPANCY ONLY. INCLUSIVE OF UTILITIES.

- FURNISHED FIRST FLOOR ROOM
- SINGLE OCCUPANCY
- SHARED KITCHEN
- SHARED LOUNGE
- SHARED BATHROOM / SHOWER
- DOUBLE GLAZING
- GAS FIRED CENTRAL HEATING
- COURTYARD REAR GARDEN
- INCLUSIVE OF UTILITIES
- \*\*\*\*6 MONTH ONLY CONTRACT\*\*\*\*

**£475 PCM**

**Ground Floor**  
Approx. 45.1 sq. metres (485.5 sq. feet)

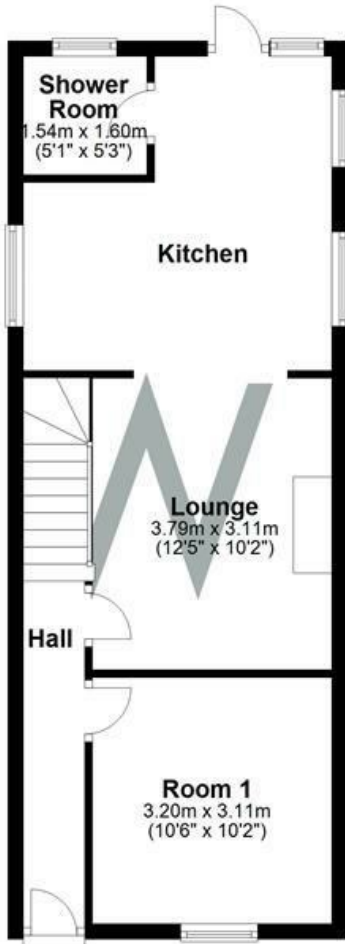

**First Floor**  
Approx. 32.9 sq. metres (353.7 sq. feet)

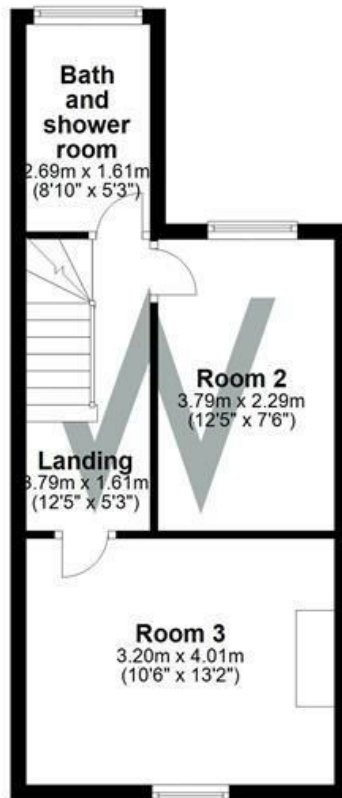

**Second Floor**  
Approx. 28.4 sq. metres (305.4 sq. feet)

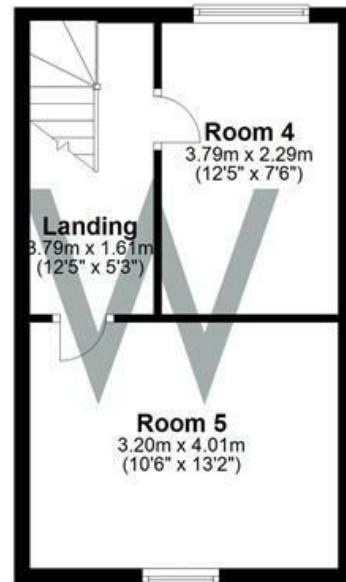

**WHITES**

Castle Chambers, 47 Castle Street, Salisbury,  
Wiltshire, SP1 3SP

Tel: 01722 336422/Option 2

www.hwwhite.co.uk

email: lettings-management@hwwhites.co.uk

Energy Efficiency Rating	Current	Potential
Very energy efficient - lower running costs		
(92 plus) <b>A</b>		
(81-91) <b>B</b>		
(69-80) <b>C</b>		
(55-68) <b>D</b>		
(39-54) <b>E</b>		
(21-38) <b>F</b>		
(1-20) <b>G</b>		
Not energy efficient - higher running costs		
<b>England &amp; Wales</b>		
	EU Directive 2002/91/EC	

Environmental Impact (CO <sub>2</sub> ) Rating	Current	Potential
Very environmentally friendly - lower CO <sub>2</sub> emissions		
(92 plus) <b>A</b>		
(81-91) <b>B</b>		
(69-80) <b>C</b>		
(55-68) <b>D</b>		
(39-54) <b>E</b>		
(21-38) <b>F</b>		
(1-20) <b>G</b>		
Not environmentally friendly - higher CO <sub>2</sub> emissions		
<b>England &amp; Wales</b>		
	EU Directive 2002/91/EC	